

NOTES:

- ITEM MATERIAL SHALL BE ALUMINUM ALLOY, ALUMINIUM ASSOCIATION TYPE 6061-T6
- SURFACES SHALL BEAR POWDER COATING, CURED, TIGER DRYLAC 39/80200, MATTE, FINE TEXTURE, COLOUR BLACK
- DIMENSIONAL REQUIREMENTS APPLY AFTER COATING
- SURFACES SHALL CONFORM TO  $\sqrt{1} \text{ A B C}$
- EXTERNAL EDGES SHALL CONFORM TO  $R0.3 \pm 0.2$
- INTERNAL EDGES SHALL CONFORM TO  $R0.2 \text{ MAX}$
- ITEM MAY BE ELASTICALLY CONSTRAINED DURING INSPECTION TO SATISFY DIMENSIONAL REQUIREMENTS

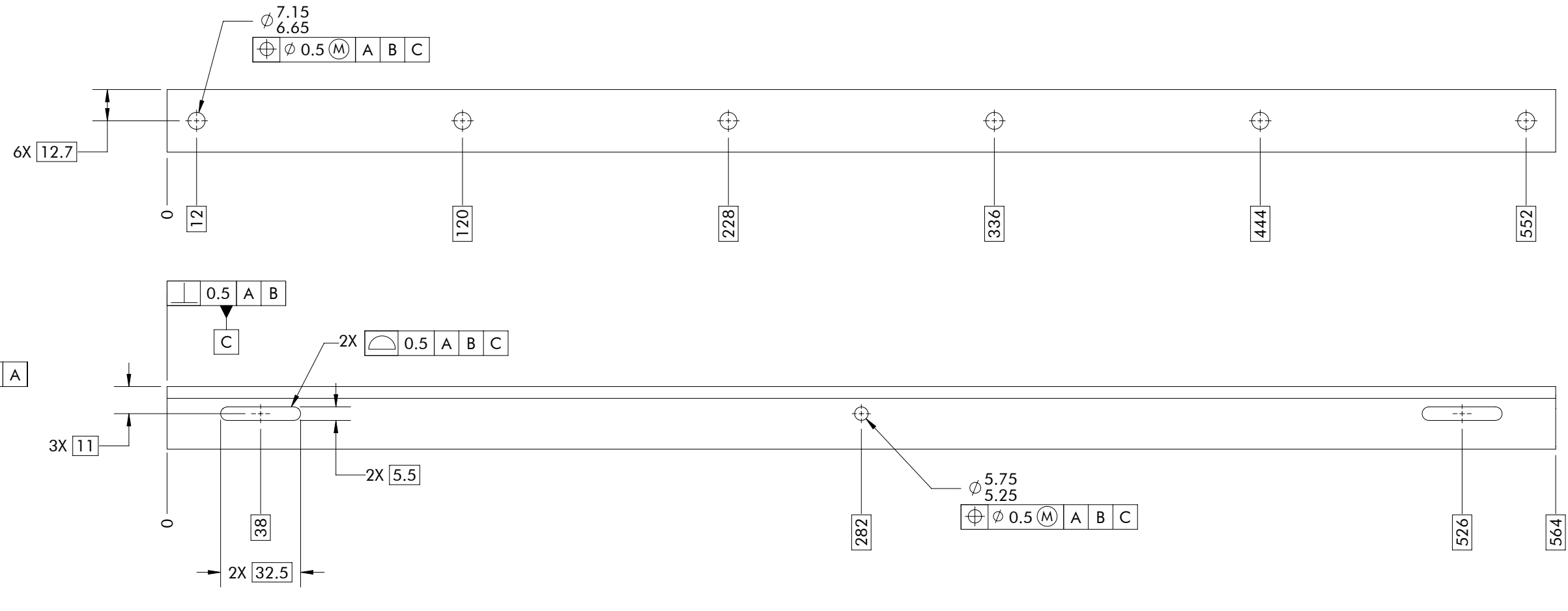

TEMPLATE 020836-DTT\_11

THIRD ANGLE PROJECTION

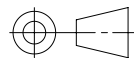

UNLESS OTHERWISE SPECIFIED

UNITS ARE MILLIMETRES & GRAMS  
 NOTES SUPERSEDE TITLE BLOCK  
 CALLOUTS SUPERSEDE NOTES  
 DIMENSIONS & TOLERANCES SHALL BE INTERPRETED  
 IN ACCORDANCE WITH ASME Y14.5-2018



PROPRIETARY AND CONFIDENTIAL  
 INFORMATION CONTAINED IN THIS DRAWING IS  
 THE SOLE PROPERTY OF CLEARPATH ROBOTICS INC.  
 PROHIBITED TO REPRODUCE IN PART OR AS A WHOLE WITHOUT  
 WRITTEN PERMISSION OF CLEARPATH ROBOTICS INC.

DRAFT JCC 9 NOV 2018

ITEM NAME

ANGLE, BRACKET—564 X 25 X 25

PAPER 432 X 279 SCALE 1:2 DO NOT SCALE

ITEM NUMBER

007848

SHEET 1 OF 1

REV.

E